

Cleaning

Clean the motor unit and chopper bowl lid only with a damp cloth. **Do not immerse the motor unit in water!**

1. All other parts can be cleaned in the dish washer. However, after processing very salty food, you should rinse the blades right away.
2. Also, be careful not to use an overdose of cleaner or decalcified in your dishwasher.
3. When processing food with color, the plastic parts of the appliance may become discolored. Wipe these parts with vegetable oil before placing them in the dishwasher.
4. Unplug the appliance before cleaning.
5. The blades are very sharp, please pay attention.

Processing Guide (for 500ml chopping bowl)

Food	Maximum	Operation time	
meat	250g	15sec	
herbs	50g	10sec	
nut, almonds	150g	15sec	
cheese	100g	10sec	
bread	80g	10sec	
onions	200g	10sec	
biscuits	150g	10sec	
soft fruit	200g	10sec	
Yeast dough	flour	250g	10sec
	water	165	
	cream	2.5	
	power	19	
	sugar	1.5	



A wish for wellness...

INSTRUCTION MANUAL



Turbo

**Hand Blender
MODEL NO.: 0104**

220-240V~, 50/60Hz, 800W

PARTS NAME:

Description:

- A. Switch
- B. Motor unit
- C. release button
- D. Blender stick
- E. Chopping bowl lid
- F. "S"blade
- G. Chopping bowl
- H. Whisk holder
- I. Whisk
- J. Bracket
- K. Vessel

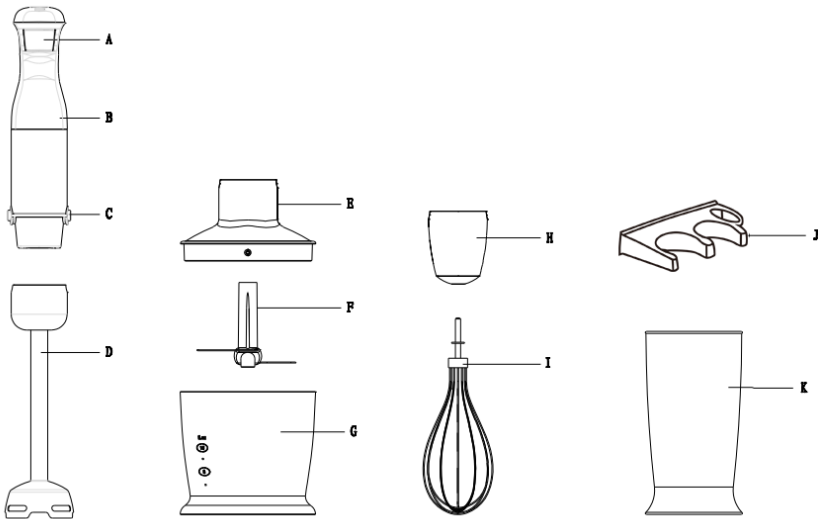

Caution:

Please read the instructions carefully and completely before using the appliance.

1. Always disconnect the appliance from the supply if it is Left unattended and before assembling, disassembling or cleaning

2. This appliance shall not be used by children. Keep the appliance and its cord out of reach of children .

3. Appliance can be used by person with reduced physical, sensory or mental capabilities or lack of experience and knowledge of they have been given supervision or instruction concerning use of the appliance in a safe way and if they understand the hazards involved

4. Children shall not play with the appliance .

5. Do not misuse the product, It may cause injury if misuse.

6. Before plugging into a socket, check whether your voltage corresponds to the rating label of the appliance.

7. Always disconnect the blender from the supply if it is left unattended and before assembling, disassembling, cleaning..

8. Don't plug the appliance into the power supply until it is fully assembled and always unplug before disassembling the appliance or handle the blade.

9. Do not operate any appliance with a damaged cord or plug or after the appliance malfunctions, or is dropped or damaged in any manner. Return appliance to the nearest authorized service facility for examination, repair or electrical or mechanical adjustment.

10. Don't let excess cord hang over the edge of the table or worktop or touch hot surface.

11. The blades are very sharp! Handle carefully!

12. Keep hands and utensils out of container while blending to reduce the risk of severe injury to persons or damage to the blender. A scraper may be used but must be used only when the blender is not running (does not apply to an acceptable scraper integral with the appliance.)

13. To protect against risk of electrical shock do not put motor unit, cord, or plug in water or other liquid.

14. This appliance should not be used by children and care should be taken when used near children,

15. Avoid contacting moving parts.

16. Do not let cord contact hot surface, including the stove.

17. Do not blend hot liquids.

18. Neither the measuring beaker, nor the chopping bowl is microwave proof.

19. Short - time operating (three times only). Use the appliance to operate soft food for no longer than 1 minute, and operate hard food for

no longer than 15 seconds. Operated 3 cycles for one use.

20. To reduce the risk of injury, never place cutting blade on base without first putting bowl properly in place.

21. Be certain cover is securely locked in place before operating appliance.

22. Clean the hand blender with dry cloth.

23. The instruction must include details on how to clean surfaces in contact with food and the operating times and speed settings for accessories.

24. It shall warn of potential injury from misuse. care shall be taken when handling the sharp cutting blades, emptying the bowl and during cleaning.

25. Switch off the appliance and disconnected from supply before changing accessories or approaching parts which move in use.

26. This appliance is not intended for use by children or other persons without assistance or supervision if their physical, sensory or mental capabilities prevent them from using it safely.

How to use the hand blender

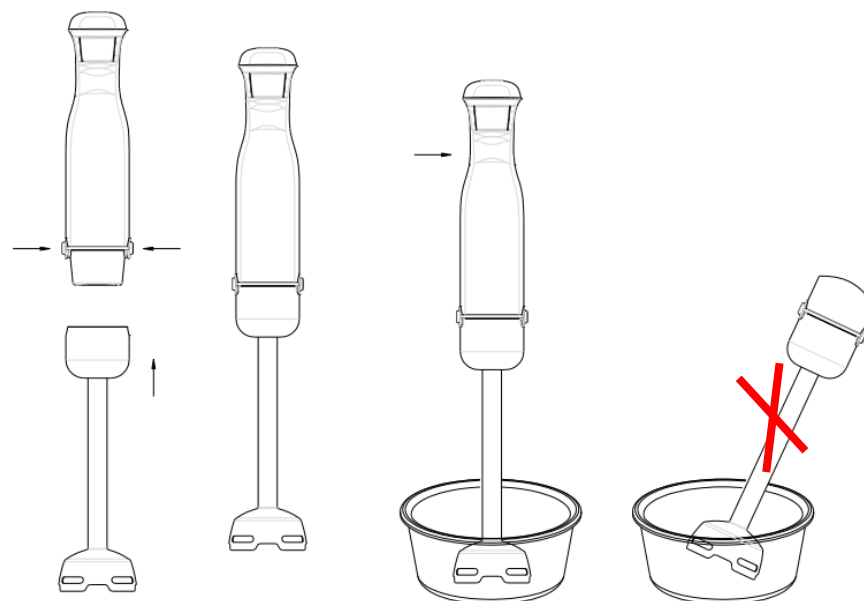

The hand blender is perfectly suited for preparing dips, sauces, soups, mayonnaise and baby food as well as for mixing and milkshakes.

1. Insert the blender stick onto the motor unit until it locks.
2. Introduce the hand blender in the vessel. Then press the switch.
3. Unplug then press the release button to remove blender stick after use.

You can use the hand blender in the measuring beaker and just as well in any other vessel.

How to use your chopper

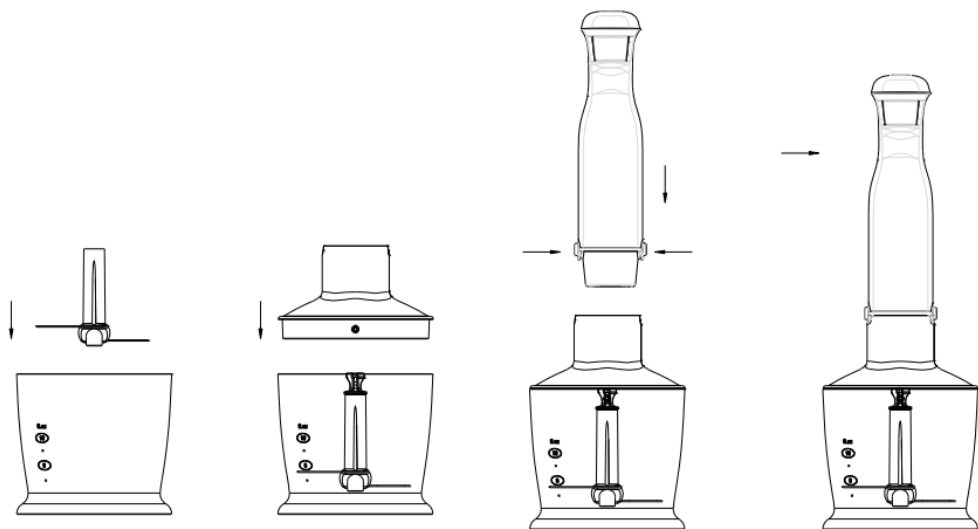

1. Chopper is perfectly suited for hard food, such as chopping meat, cheese, onion, herbs, garlic, carrots, walnuts, almonds, prunes etc.
2. Don't chop extremely hard food, such as ice cubes, nutmeg, coffee beans and grains.

Before chopping...

1. Carefully remove the plastic cover from the blade. **Caution: the blade is very sharp!** Always hold it by the upper plastic part.
2. Place the blade on the center pin of the chopper bowl. Press down the blade and lock bowl. Always place the chopper bowl on the anti-slip base.
3. Place the food in the chopper bowl.
4. Place the chopping bowl lid on the chopper bowl.
5. Place the motor unit on the chopping bowl lid until it locks.
6. Press switch to operate the chopper. During processing, hold the motor unit with one hand and the chopper bowl the other.
7. After use, unplug then press the ejection button to remove the motor unit.
8. Then remove the chopping bowl lid.
9. Carefully take out the blade.
10. Remove the processed food from the chopper bowl.

How to use your whisk

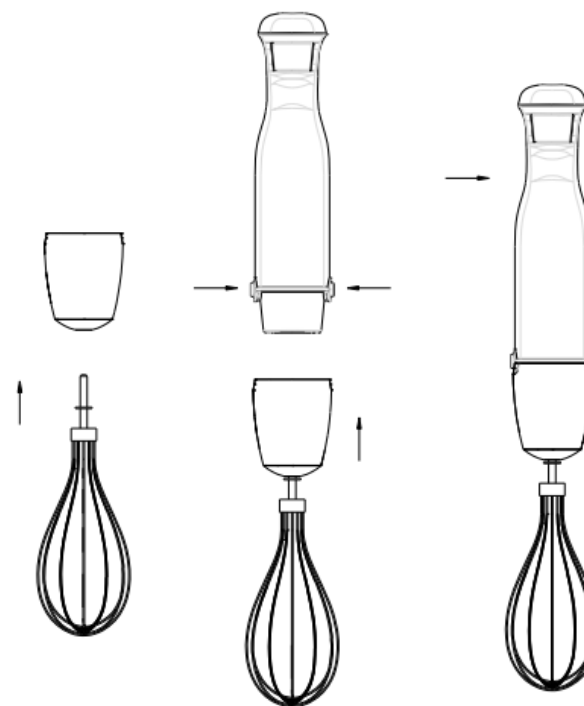

Use the whisk only for whipping cream, beating egg whites and mixing sponges and Ready-mix desserts.

1. Insert the whisk into the whisk holder, and then slot the gear box onto the motor unit until it locks.
2. Place the whisk in a vessel and only then. Press the switch to operate it.
3. Unplug then press the ejection button to remove the gear box after use. Then pull the whisk out of the gear box.