



A wish for wellness...

Range Hood

Owners Manual

CONTENT

INTRODUCTION.....	1
SAFETY PRECAUTION.....	1
WALL MOUNTING INSTALLATION.....	2
PREPARE FOR INSTALLATION	2
INSTALLATION (VENT OUTSIDE).....	3-6
INSTALLATION (VENT INSIDE)	7
ISLAND MODEL INSTALLATION.....	8-9
DOWN DRAFT MODEL NSTALLATION.....	10-11
TELESCOPIC MODEL	12
CANOPYMODEL.....	13
OPERATION	14-26
MAINTENANCE	27-28
TROUBLESHOOTING.....	29
ENVIRONMENTAL PROTECTION.....	29

INTRODUCTION

Thank you for choosing this cooker hood.

This instruction manual is designed to provide you with all required instructions related to the installation, use and maintenance of the appliance.

In order to operate the unit correctly and safely, please read this instruction manual carefully before installation and usage.

The cooker hood use high quality materials, and is made with a streamlined design. Equipped with large power electric motor and centrifugal fan, it also provides strong suction power, low noise operation, non-stick grease filter and easy assembly installation.

SAFETY PRECAUTION

Never let the children operate the machine.

The cooker hood is for home use only, not suitable for barbecue, roast shop and other commercial purpose.

The cooker hood and its filter should be clean regularly in order to keep in good working condition.

Clean the cooker hood according to the instruction manual and keep the unit from danger of burning. There is a fire risk if cleaning is not carried out in accordance with the instructions.

Forbid the direct baking from the gas cooker.

Please keep the kitchen room a good convection.

Before connecting this appliance check that the power supply cord is not damaged. A damage supply cord must be replaced by qualified service personnel only.

There shall be adequate ventilation of the room when the range hood is used at the same time as appliances burning gas or other fuels;

The air must not be discharged into a flue that is used for exhausting fumes from appliances burning gas or other fuels;

Regulations concerning the discharge of air have to be fulfilled.

This appliance is not intended for use by persons (including children) with reduced physical, sensory or mental capabilities, or lack of experience and knowledge, unless they have been given supervision or instruction concerning use of the appliance by a person solely for their safety.

Children should be supervised to ensure that they do not play with the appliance.

Do not flame under the range hood.

CAUTION: Accessible parts may become hot when used with cooking appliance.

This appliance can be used by children aged from 8 years and above and persons with reduced physical, sensory or mental capabilities or lack of experience and knowledge if they have been given supervision or instruction concerning use of the appliance in a safe way and understand the hazards involved. Children shall not play with the appliance. Cleaning and user maintenance shall not be made by children without supervision

If the supply cord is damaged, it must be replaced by the manufacturer, its service agent or similarly qualified persons in order to avoid a hazard.

Electrical Shock Hazard

Only plug this unit into a properly earthed outlet. If in doubt seek advice from a suitably qualified engineer.

Failure to follow these instructions can result in death, fire, or electrical shock.

WALL MOUNTING INSTALLATION

1. Prepare for installation:

- a. If you have an outlet to the outside, your cooker hood can be connected as below picture by means of an extraction duct (enamel, aluminum, flexible pipe or inflammable material with an interior diameter of 150mm)

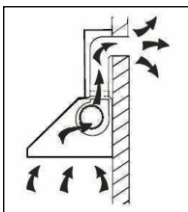

- b. Before installation, turn the unit off and unplug it from the outlet.

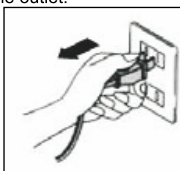

- c. The cooker hood should be placed at a distance of 65~75cm above the cooking plane for best effect.

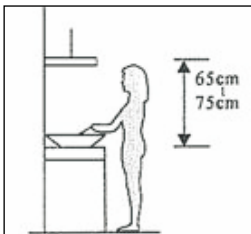

2. Installation (Vent outside):

Attention! Observe the warning in the instruction sheet concerning the operation of the appliance when air is discharged from the room.

Warning: Failure to install the screws or fixing device in accordance with these instructions may result in electrical hazards

When the range hood and appliance supplied with energy other than electricity are simultaneously in operation, the negative pressure in the room must be not exceed 4 Pa (4×10^{-5} Bar)

- Drill 3 x 8mm holes to accommodate the bracket. Screw and tighten the bracket onto the wall with the screws & screw plugs provided.

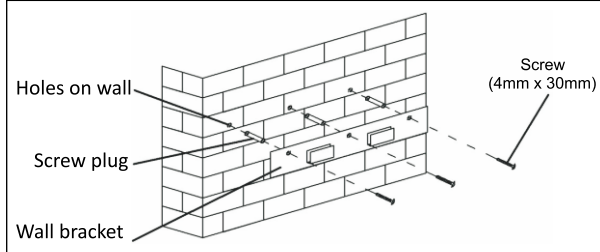

- For inclined panel Model, need to drill 4 x 8mm extra holes & fixing screws & screw plugs before installation.

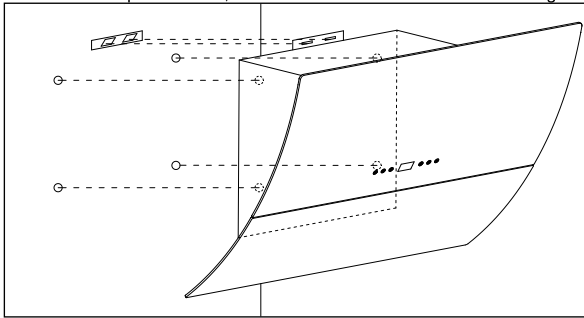

- Leave up the cooker hood and hang onto the wall bracket hook.

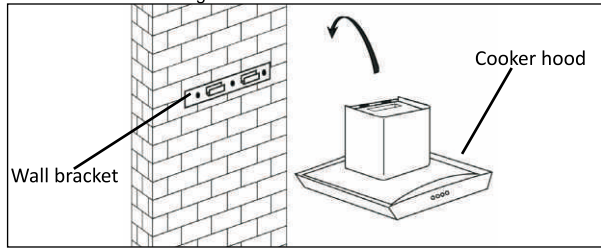

- Fix the one-way-valve to the air outlet of the cooker hood. Then, attached the exhaust pipe onto the one-way-valve as shown below.

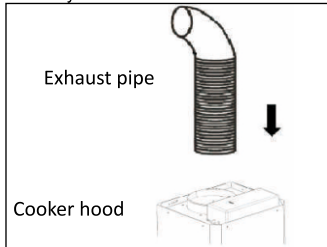

- Chimney installation.

For Glass model and T shape model

- ◆ By Put the upper chimney into lower chimney .Then pulling out the upper chimney upwards. Adjust to reach the height required.

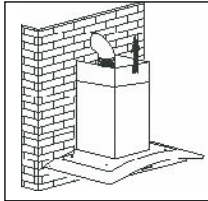

- ◆ Sliding the chimney to adjust the chimney height. When the height you required is reached, then hang the fixing hole to the fixing screws as showed in below pictures.

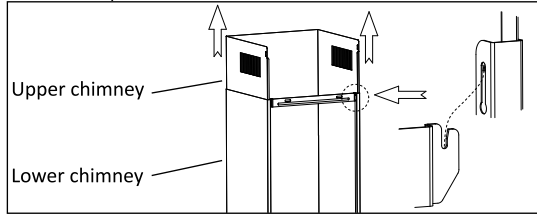

- ◆ Drill $2 \times 8\text{mm}$ holes to accommodate the plate II. Screw and tighten the plate II onto the wall with 2 screws provided. Assemble the chimney onto the unit and fix it with 2 screws.

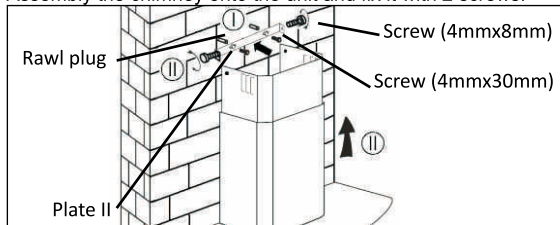

For Tower model

- ◆ By Put the inner chimney into upper chimney .Then pulling out the upper chimney upwards. Adjust to reach the height required.

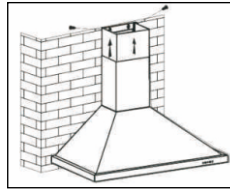

- ◆ Fix the lower chimney with 2 pcs of 4x8mm screws.

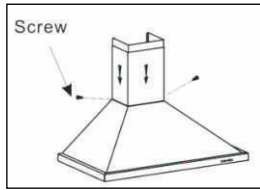

- ◆ Sliding the chimney to adjust the chimney height. When the height you required is reached, then fix 2 pcs of 4x8mm screws onto the hole fixing with plate I as showed in below pictures.

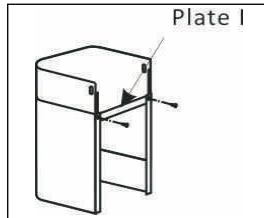

- ◆ Drill 2 x 8mm holes to accommodate the plate II. Screw and tighten the plate II onto the wall with 2 screws provided.
- ◆ Assembly the chimney onto the unit and fix it with 2 screws.

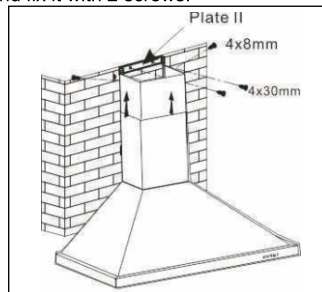

Installation (Vent inside)

If you do not have an outlet to the outside, exhaust pipe is not required and the installation is similar to the one show in section "**Installation (Vent outside)**".

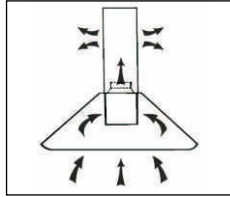

Activated carbon filter can be used to trap odors.

In order to install the activated carbon filter, the grease filter should be detached first. Press the lock and pull it downward.



Plug the activated carbon filter into the unit and turn it in clockwise direction. Repeat the same on the other side.

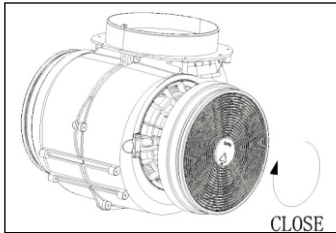

NOTE:

- *Make sure the filter is securely locked. Otherwise, it would loosen and cause dangerous.*
- *When activated carbon filter attached, the suction power will be lower.*

ISLAND MODEL INSTALLATION

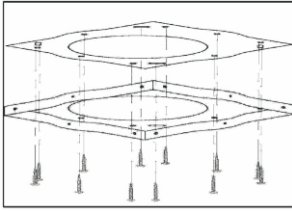

1) Position the hanging plate on the ceiling and then mark the position of the screw holes. The hanging plate should be securely fixed to the ceiling,

- 11 x ST6 (40 mm) screws for wooden ceiling
- 8 x expansion bolts for cement ceiling

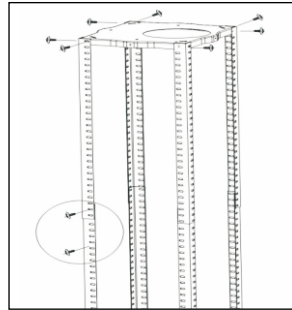

2) Fix the angle bars to the hanging plate, using the 8 x M5 screws.

3) Extend the angle bars to the required height and then fix them in position using the 16 x M5 screws and nuts with metal washers.

- **IMPORTANT:** The angle bars must have an overlap of AT LEAST 100 mm.

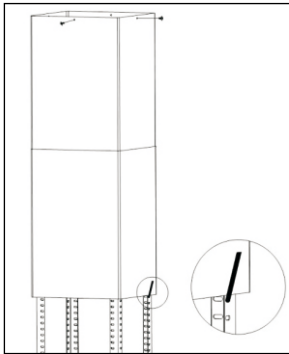

4) If your cooker hood is going to be used in extraction mode, then you should connect the ducting hose to the ceiling adaptor at this point.

Fix the upper chimney section to the hanging plate, using the 4 x self tapping screws.

Slide the lower chimney section onto the angle bars and raise it until it sits just below the upper chimney section.

Way two:

- Drill 4 holes of 6mm diameter at the bottom of the hanging cupboard
- Put the one way valve on the cooker hood, then install the cooker hood on the bottom of the hanging cupboard, tighten the hood with enclosed 4 screws.

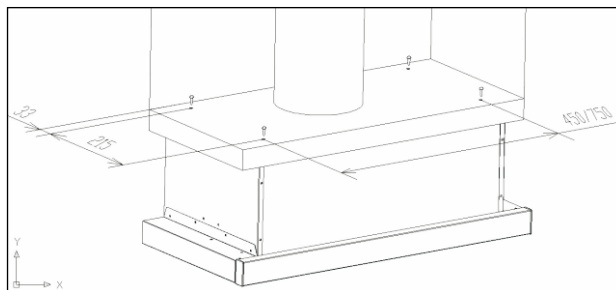

Note:

1. The extensible pipe are optional accessory, not supplied.
2. Take off protection film before installation.

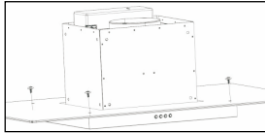

5) If the glass canopy has not been pre-assembled by the factory, then it should be fixed to the top of the main body of the cooker hood at this stage.

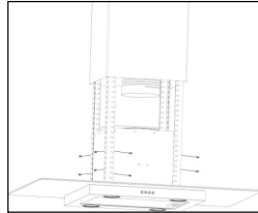

6) Lift the main body of the cooker hood onto the angle bar and then fix it into position using the 16 x M5 screws.

- **IMPORTANT:** This stage of the installation process **MUST** be completed by two people.
- **IMPORTANT:** The 16 x M5 screws **MUST** be securely tightened.



7) If you are going to be using the hood in Extraction mode, you should fix the ducting Hose to the ceiling.

- The electrical connection must correspond to the electrical requirement noted on the rating plate, which is placed inside the cooker hood. The appliance should now be connected to the electrical supply.
- Check that the appliance is operating correctly by selecting each speed and switching the light bulbs on and off.
- Remove the hanging hook and then slide the lower chimney section downwards, until it rests against the main body of the cooker hood.
- Use a stainless steel cleaner and polish on the stainless steel sections of the appliance.
- If you are using the appliance in recirculation mode, then you should now fit the carbon filter. See the "fitting the carbon filter" section on page 9.

Downdraft model

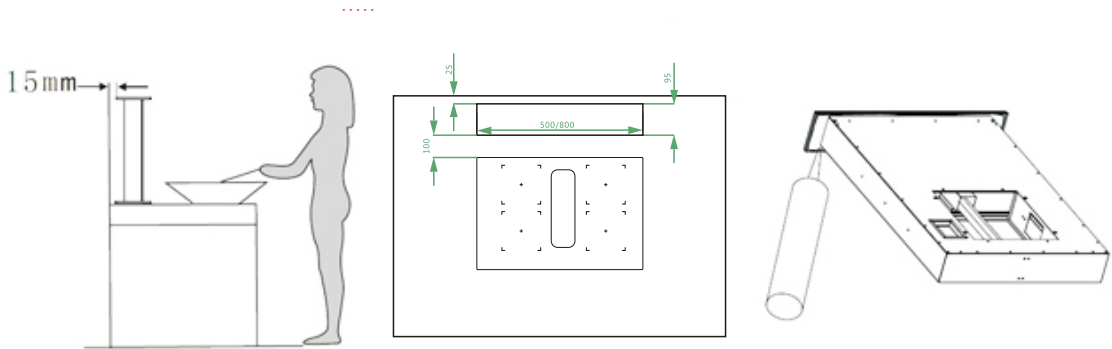

Pic 1

Pic 2

Pic 3

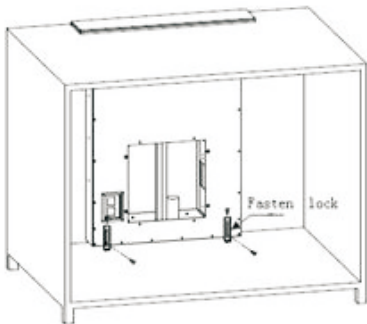

Pic 4

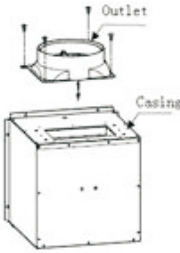

Pic 5

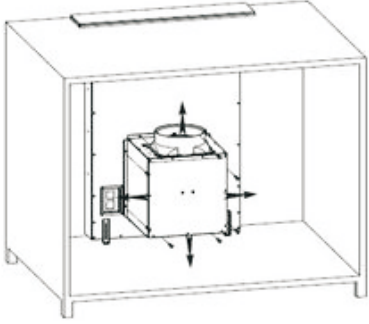

Pic 6

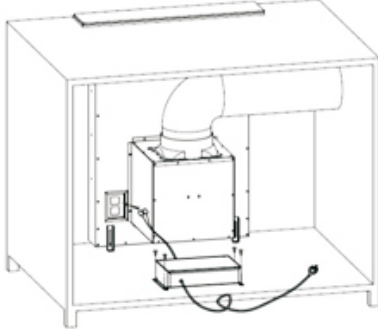

Pic 7

-
- 1)** The cooker hood should be placed at a distance of 15mm from the wall at least. (See Pic1).
 - 2)** Put moderate glass cement on the edge of the panel bottom(See pic 3), and put the hood into the hole of the cabinet.(See pic 2) Use 4pcs screw ST4*8 & screw ST4*14 & fixing knock to fix the hood.(See pic 4).
 - 3)** Fix the outlet on the casing by 4pcs screw ST4*8. (See pic 5)
 - 4)** Connect the casing & hood by 8pcs screw M10*10, the wind direction are up, down, left, right, the user can select according to the space of the cabinet.(See pic 6).
 - 5)** Fix the pipe on the outlet, and use 4pcs screw ST4*14 to fix the PCB box, connect the power and finish the installation.(See pic 7).

TELESCOPIC MODEL INSTALLATION

Way one:

- To install onto the wall drill 2 holes of $\varnothing 8\text{mm}$ on a suitable place according with the centre distance of hole in the back of the cooker hood.
- Insert the nut into the holes.
- Insert the screws into the nuts and tight. Put the cooker hood onto the tighten screws.

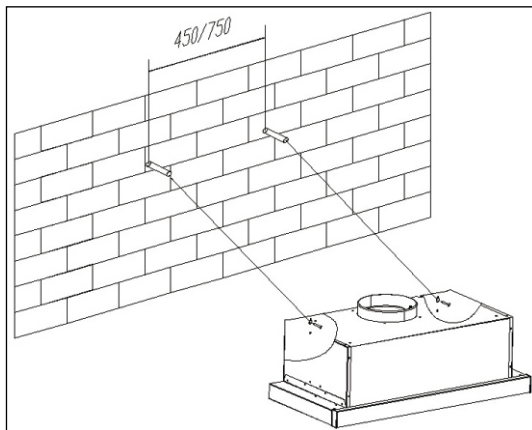

- Fix the cooker hood with safety screw. The two safety vents are positioned on the back casing, with diameter of 6mm.
- Put the one way valve onto the cooker hood.

Canopy MODEL INSTALLATION

- 1) Remove the metal grease filter (A).
- 2) Create an opening in the underneath of the kitchen unit; the cut-out must be of the dimensions shown in the drawing below: for 520/600/750/900mm model:

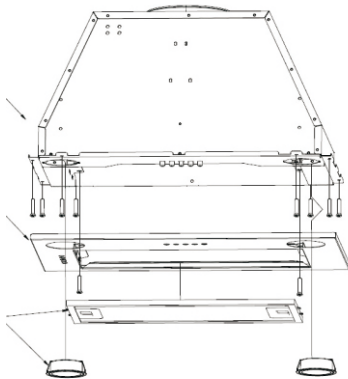
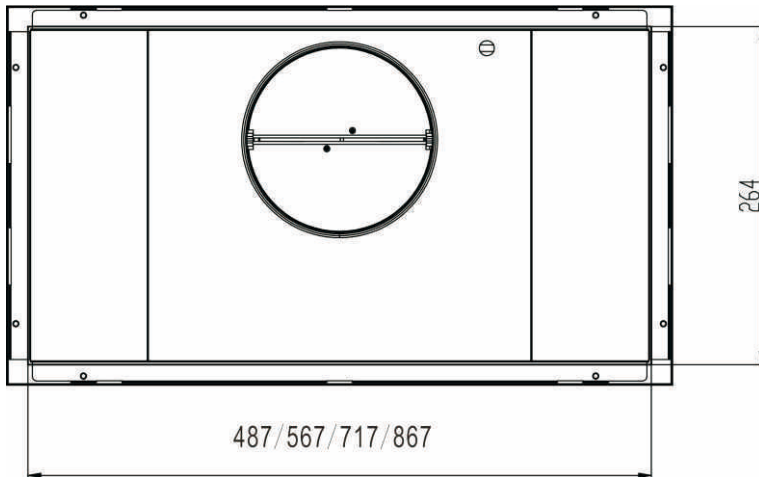

3) Make a hole in the inside of the kitchen unit for the electrical cable to feed through. Remove the screws securing the extractor frame (**B**) to the hood and unscrew the 2 lights. Ensure that the two support clips on either side of the hood are set to accommodate the thickness of the mounting surface, by adjusting the clip via the screw.

4) Lift the cooker hood towards the cut-out that you made in step 2. Feed the electrical cable through the hole that you made in step 3. **IMPORTANT:** Do not connect the electrical cable to the mains supply at this stage.

5) Lift the cooker hood fully into the cut out that you made in step 2. If you are connecting the cooker hood to external ducting, then secure the ducting hose to the coupling on the appliance.

- One person should support the hood. The other person should fully tighten the support screws through the pre-drilled holes in the outer frame of the hood, into the kitchen unit. Then replace the extractor frame using the 2 screws (**B**) and reattach the 2 lights.
- Refit the grease filter.

OPERATION

Mechanical Rocker button

It just appear in TELESCOPIC MODEL.



Light button On the left side of hood.



Speed button On the right side of hood.

“=”: high speed level.

“—”: Low speed level.

“O”: Off

Push button/Electronic button 1



0 Off button

It's used for turning off the fan.

Low Speed button

It's used for Ventilation on the kitchen. It is suitable for simmering and cooking which do not make much steam.

Medium Speed button

Airflow speed is ideally for ventilation in standard cooking operation.

High Speed button

When high density of smoke or steam produced, press high-speed button for highest effective ventilation.

Light button

Electronic button 2



Low Speed button

It's used for Ventilation on the kitchen. It is suitable for simmering and cooking which do not make much steam.

Medium Speed button

Airflow speed is ideally for ventilation in standard cooking operation.

High Speed button

When high density of smoke or steam produced, press high-speed button for highest effective ventilation.

Light button

NOTE: If Low / Medium / High speed buttons are press at the same time, the unit will only operate at the highest speed.

Touch control 1

Touch Control



On/Off button– Depress this button to turn on/off the motor

Speed –select speed to suit cooking conditions

- 1 Low –Depress this button to enter into low speed and again to turn off motor.
- 2 Medium –Depress this button to enter into medium speed and again to turn off motor
- 3 High –Depress this button to enter into high speed and again to turn off motor

Lamp – Turn on/off light

Touch control 2



On/Off button
It's used for turning on/off the fan.

Speed plus button
For increasing the speed of the fan

Speed decrease button
For decreasing the speed of the fan.

Light button

Digital display
Fan speed display: "1" for Low speed, "2" for Medium speed, "3" for High speed.

Quick timer: Press **+** & **-** hold for 1 second, Digital display will flashing & into 5 minutes count down, after 5 minutes motor & light will turn off automatic & Buzzer sound for 1 second.

Touch control 3



After plug in power, will into Stand By mode automatic.

Timer button
Time setting, keep pressing it in stand by mode, into time setting, hour display flashing, press "**+**" or "**-**" for setting, press "⌚" change to minute setting, press "**+**" or "**-**" for setting, press "⌚" again or wait 5s finish time setting.

Timer setting, short press during working mode, pre-set cycle :off→15mins→30mins→45mins→60mins→off, "**+**" or "**-**" for adjusting timer time, except "off" timer setting.

Quick timer: Press **+** & **-** hold for 1 second, Digital display will flashing & into 5 minutes count down, after 5 minutes motor & light will turn off automatic & Buzzer sound on.

Speed plus button
For increasing the speed of the fan

Speed decrease button
For decreasing the speed of the fan.

Light button
Short press for lamp power control.

Long press

1. For turning off the "Cleaning symbol" & reset total working time when "Cleaning symbol" is on & motor or lamp is on.
2. For checking current total working time when "Cleaning symbol" is off.

LCD display



1. Fan symbol, will turn when the fan is working
2. Time display
3. Timer
4. Light
5. Fan speed
6. Alarm symbol
7. Cleaning symbol, appear when total working time up to 14 hours.

Touch control 4(Normal model)

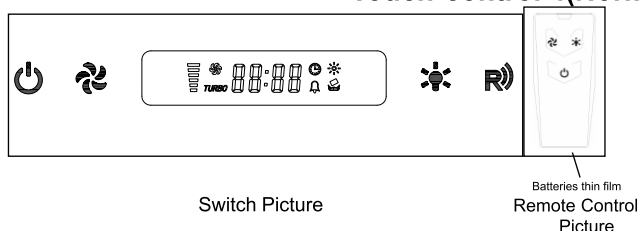



Before use the remote control please Remove the battery film!



STANDBY MODE.

After plug in, just  flashing slowly, system in **STANDBY MODE**.

"ON/OFF" key:

In **STANDBY MODE** press  display & all buttons light on, hood in **WORKING MODE**. If it's the first time start up motor working in **LOW** speed & light off automatically; or recover from the same setting of last working operation. **(Same for  in Remote control)**

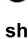
In **WORKING MODE**, press , motor stop working, but light will not change statue

In **WORKING MODE**, press  & hold for 3 seconds, Motor & light stop working, back to **STANDBY MODE**. **(Same for  in Remote control with short press)**

All other buttons just could work in **WORKING MODE**.

"FAN SPEED" key:

Button for changing the speed of motor following cycle "Low-Middle-High". (This key could not stop motor working.)

(Same for  in Remote control)



"Light" button

Short press for lamp power control.

Long press

1. For turning off the "Cleaning symbol" & reset total working time when "Cleaning symbol" is on.
2. For checking current total working time when "Cleaning symbol" is off.

CLOCK SETTING



In **STANDBY MODE**, press  +  & hold for 1 second, the "88:88" flashing & enter the **CLOCK SETTING MODE**.

In this state: pressing  for changing selecting hour or minute

pressing  key for increase

If press  +  Or without no any operation in **CLOCK SETTING MODE** for 5 seconds, will save automatically & exit **CLOCK SETTING MODE**.

TIMER SETTING

When motor is working, press  +  & hold for 1 second, display flashing shows "00:00", enter the **TIMER SETTING MODE**.

In this state: pressing  for increase 15 minutes

pressing  for decrease 1 minute.

pressing  for increase 1minute.

If press  +  key or without no any operation in **CLOCK SETTING MODE** for 5 seconds, will save automatically start to count down showing in display.

When time up, both motor & light will turn off automatically & come back to **STANDBY MODE**

LCD display:
Same as the TOUCH CONTROL 2.

Touch control 5(Automatic window model)

Start using your range hood

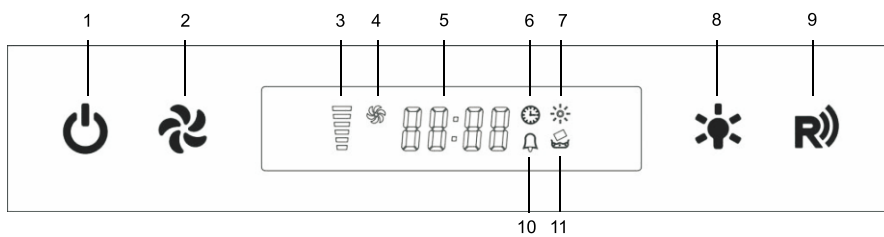

1. On/off button
2. Fan speed adjustment button
3. Fan speed indication bar
4. Fan running indicator
5. Time display
6. Timer indicator

7. Light On indicator
8. Lamp On/off button
9. Remote receiver position
10. Alarm display
11. Clean reminder(See Maintenance and cleaning)



On/Off – Turn on/off unit



Lamp – Turn on/off light;



Speed –select speed to suit cooking conditions, press it speed will loop as low-mid-high speed.  will turn on to indicate motor is running.



Low – light frying/boiling.



Medium – frying/wok cooking/heavy boiling.







High – grilling, intensive frying and wok cooking.



STANDBY MODE.

After plug in,  flashing slowly, system in standby mode.

O'CLOCK SETTING



In standby mode, press  and  together and hold for 1 second, the "88:88" flashing, now you can start

O'clock setting. Press  and hour segment flashing, use  to increase and  to decrease hour, Press





 and minute segment flashing, use  to increase and  to decrease minute. Wait for 5 seconds no operation, then setting is confirmed

WORKING MODE.

In standby mode, press , the windows will open, display & all button light will turn on and enter in working mode. Now you can start choosing fan speed.

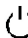
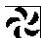
If press  once, motor stop working, but light will not change statue. If you want to turn off all, press  and hold for 3 seconds, motor, light will stop working and window start backing, system will come back to standby mode.

TIMER SETTING

To set timer. when motor is working, press  and  together and hold for 1 second, display flashing shows "01:00", then use  to increase or  to decrease by 1 minute. Press  can enable you increase by 15 minutes.

When desired working duration set, wait for 5 seconds without no any operation then timer is confirmed,  turn on and system start counting down. When time is up, motor and light turn off (but the windows will not close)

MANUAL CLEARING MODE

For cleaning operation:

In **STANDBY MODE**, press & hold  for 3 seconds,(it must operate with the control panel on the hood) window open automatically. When the window opening complete, display as **STANDBY MODE**.

In **MANUAL CLEARING MODE**, press & hold  for 3 seconds(it must operate with the control panel on the hood), window close automatically. When the window closing complete, system comes back to **STANDBY MODE**.

(Same for  in Remote control with short press)

Automatic Anti-clamp functions:

During the case of window closing, if there is obstruction, the operation will stop immediately & window runs to opposite direction till fully open, then it will close again. If without obstruction, window will close completely. Otherwise, it will open again, but this time, it will not close after fully opening, unless by separate manual operation.

REMOTE CONTROLLER

Your range hood equipped with remote controller to allow you operate the unit remotely.

Before use the remote control please remove the battery film!

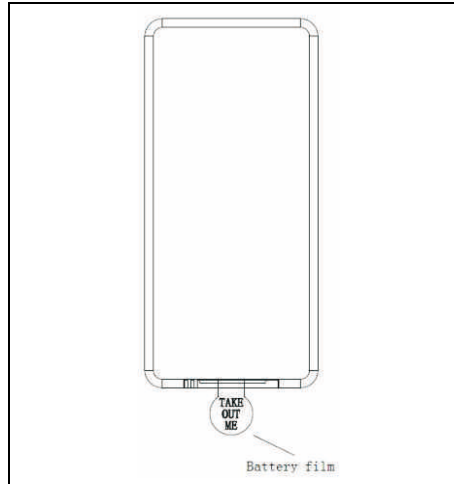
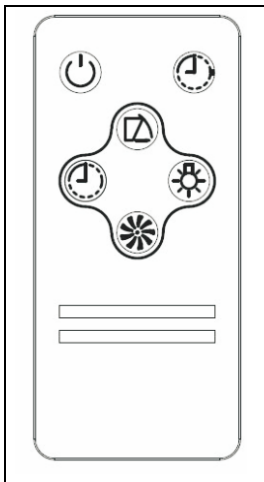

Replace battery

1. Prize up the back cap.

2. Replace CR2032 battery

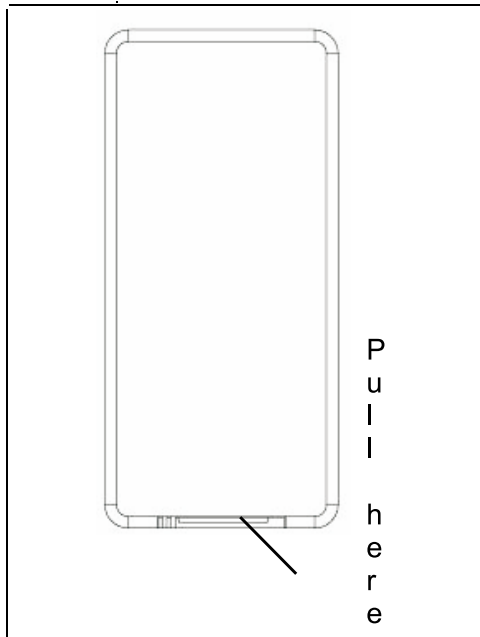

Below shadow area is effective remote controlling area for better using the remote control.

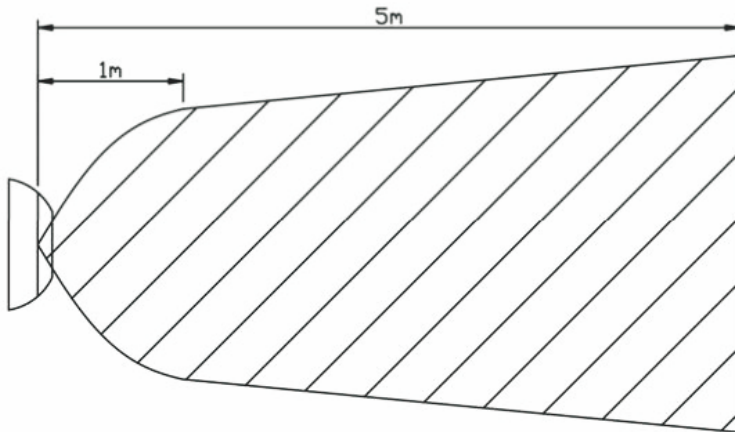

Touch control 6 (Heart & Smoke sensor model)

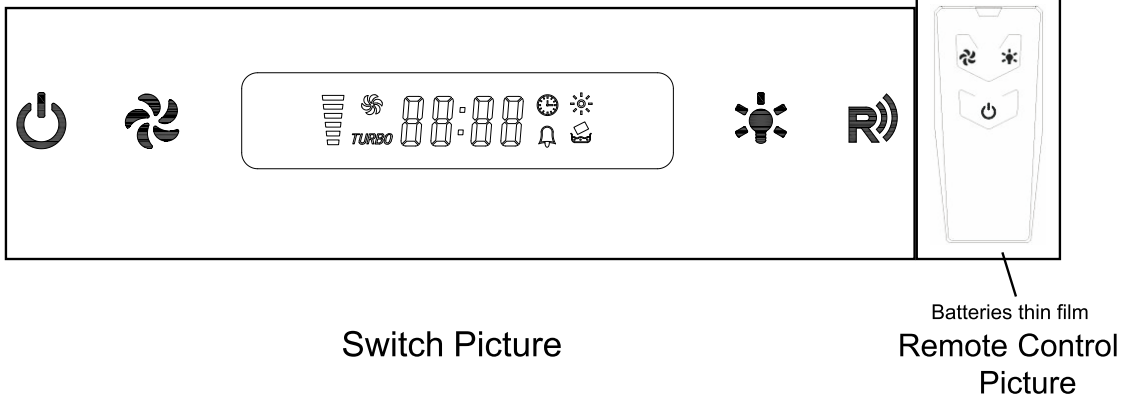



Before use the remote control please Remove the battery film!

STANDBY MODE.

After plug in, just  flashing slowly, system in **STANDBY MODE**.

"ON/OFF" key:

In **STANDBY MODE** press  display & all buttons light on, hood in **WORKING MODE**. If it's the first time start up motor working in LOW speed & light off automatically; or recover from the same setting of last working operation. (**Same for  in Remote control**)

In **WORKING MODE**, press , motor stop working, but light will not change statue

In **WORKING MODE**, press  & hold for 3 seconds, Motor & light stop working, back to **STANDBY MODE**. (**Same for  in Remote control with short press**)

All other buttons just could work in **WORKING MODE**.



"FAN SPEED" key:

Button for changing the speed of motor following cycle "Low-Middle-High". (This key could not stop motor working.)

(Same for  in Remote control)



"Light" button

Short press for lamp power control.

Long press

1. For turning off the "Cleanning symbol" & reset total working time when "Cleanning symbol" is on.
2. For checking current total working time when "Cleanning symbol" is off.



CLOCK SETTING

In **STANDBY MODE**, press  +  & hold for 1 second, the "88:88" flashing & enter the **CLOCK SETTING MODE**.



In this state: pressing  for changing selecting hour or minute

pressing  key for decrease.

pressing  key for increase

If press  +  key or without no any operation in **CLOCK SETTING MODE** for 5 seconds, will save automatically & exit **CLOCK SETTING MODE**.



TIMER SETTING

When motor is working, press  +  & hold for 1 second, display flashing shows "00:00", enter the **TIMER SETTING MODE**.

In this state: pressing  for increase 15 minutes



pressing  for decrease 1 minute.

pressing  for increase 1minute.

If press  +  key or without no any operation in **CLOCK SETTING MODE** for 5 seconds, will save automatically start to count down showing in display.

When time up, both motor & light will turn off automatically & come back to **STANDBY MODE**

AUTO(HEAT & SMOKE SENSOR) MODE

In **STANDBY MODE**, press  +  & hold for 1 second, working mode stop & into gather mode(sensor collecting ambient information for 1min).After 1min LED display showing "AUTO" means into AUTO mode. sensor monitor non-stop.

 button could stop AUTO mode and come back to **STANDBY mode**

LCD display:

Same as the **TOUCH CONTROL 2.**

Touch control 7

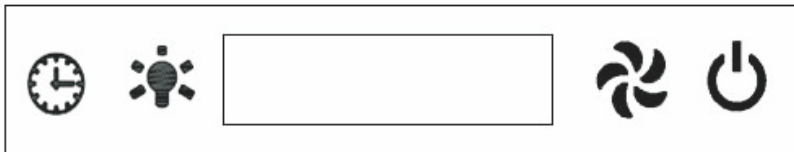

 "ON/OFF" key:

 "Light" button

 "FAN SPEED" key:

Button for changing the speed of motor following cycle "Low-Middle-High".

 **CLOCK SETTING**

In **STANDBY MODE**, press  button enter the **CLOCK SETTING MODE.**

pressing  key for increase 1 hour

pressing  key for decrease 1 hour

press  button again to enter minute

pressing  key for increase 1 minute

pressing  key for decrease 1 minute

press  the third time will save automatically & exit **CLOCK SETTING MODE**.

TIMER SETTING

When motor is working, press , display flashing shows "5:00", enter the **TIMER SETTING MODE**.

In this state: pressing  key for increase 1 minute

pressing  key for decrease 1 minute

press  key again, will save automatically start to count down showing in display.

When time up, both motor & light will turn off automatically & come back to **STANDBY MODE**

LCD display



Touch Control 8 (SS touch control)



Off button



It's used for turning off the fan.



Low Speed button

It's used for Ventilation on the kitchen. It is suitable for simmering and cooking which do not make much steam.



Medium Speed button

Airflow speed is ideally for ventilation in standard cooking operation.



High Speed button

When high density of smoke or steam produced, press high-speed button for highest effective ventilation.



Light button

TOUCH CONTROL 9



"ON/OFF" key:

It's used for turning on/off the fan.



"FAN SPEED" key:

Button for changing the speed of motor following cycle "Low-Middle-High".





"Digital display"

Fan speed display: "1" for Low speed, "2" for Medium speed, "3" for High speed.



"Light button"

Quick timer: Press  &  hold for 1 second, Digital display will flashing & into 5 minutes count down, after 5 minutes motor & light will turn off automatic & Buzzer sound for 1 second. (Same as Press  from remote control)

MAINTENANCE

Before cleaning switch the unit off and pull out the plug.

I. Regular Cleaning

Use a soft cloth moistened with hand-warm mildly soapy water or household cleaning detergent. Never use metal pads, chemical, abrasive material or stiff brush to clean the unit.

II. Monthly Cleaning for Grease Filter

ESSENTIAL: Clean the filter every month can prevent any risk of fire.

The filter collects grease, smoke and dust..... so the filter is directly affecting the efficiency of the cooker hood. If not cleaned, the grease residue (potential flammable) will saturate on the filter. Clean it with household cleaning detergent.

III. Annual Cleaning for Activated Carbon Filter

Apply SOLELY to unit that installed as a recirculation unit (not vented to the outside). This filter traps odours and must be replaced at least once a year depending on how frequent the cooker hood used.

IV. Bulb Replacement

1. Switch the unit off and unplug the appliance.
 2. Remove the lamp cover by unscrewing the 2 screws.
 3. Unscrew the incandescent bulb
 4. Replace with the same type and rated bulb/lamp
- I E14 Incandescent Bulb: (220V E14 Max 40W).

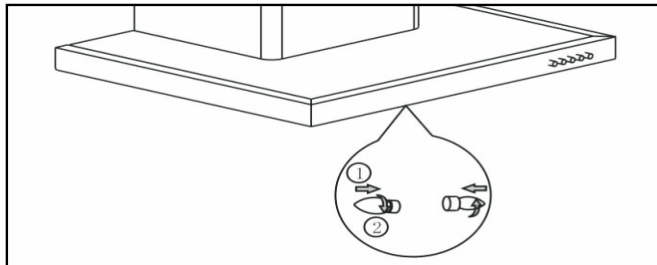

- I Halogen lamp (max, 20W) & LED lamp (max, 1.5W).

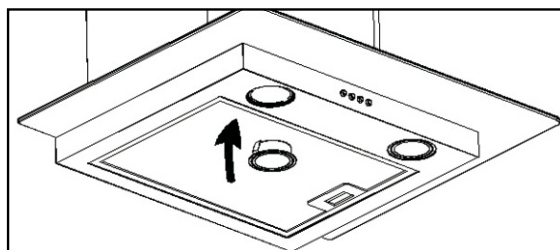

I For Slim model.

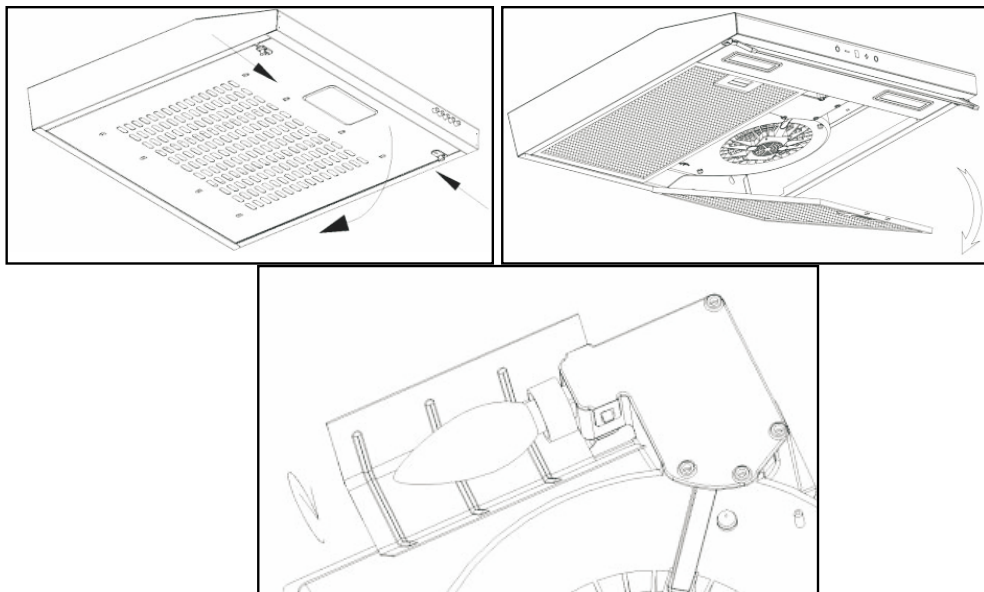

TROUBLESHOOTING

Fault	Cause	Solution
Light on, but fan does not work	The fan blade is jammed.	Switch of the unit and repair by qualified service personnel only.
	The motor is damaged.	
Both light and fan do not work	light bulb burn.	Replace the bulb with correct rating.
	Power cord looses.	Plug in to the power supply again.
Serious Vibration of the unit	The fan blade is damaged.	Switch of the unit and repair by qualified service personnel only.
	The fan motor is not fixed tightly.	Switch of the unit and repair by qualified service personnel only.
	The unit is not hung properly on the bracket.	Take down the unit and check whether the bracket is in proper location.
Suction performance not good	Too long distance between the unit and the cooking plane	Readjust the distance to 65-75cm

ENVIRONMENTAL PROTECTION

Waste electrical products should not be disposed of with household waste. Please recycle where facilities exist. Check with your Local Authority or retailer for recycling advice.



This appliance is marked according to the European directive 2012/19/EC on Waste Electrical and Electronic Equipment (WEEE).

By ensuring this product is disposed of correctly, you will help prevent potential negative consequences for the environment and human health, which could otherwise be caused by inappropriate waste handling of this product.

The symbol on the product indicates that this product may not be treated as household waste. Instead it shall be handed over to the applicable collection point for the recycling of electrical and electronic equipment

Disposal must be carried out in accordance with local environmental regulations for waste disposal.

For more detailed information about treatment, recovery and recycling of this product, please contact your local city office, your household waste disposal service or the shop where you purchased the product
