



A wish for wellness...

USER MANUAL

Turbo Blender

0803

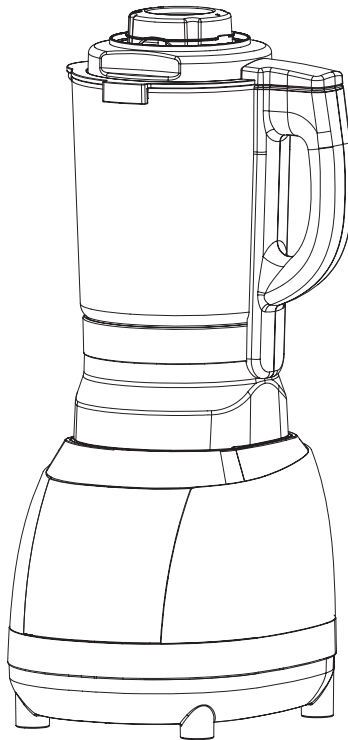

Pictures are for reference, not exactly same as the product.

Contents

Direction for Safety in Use	1
Attention to Safety	2
Schematic Diagram	4
of Components	
Direction for Use	5
Usage	6
Cleaning and Maintenance	8
Schematic Circuit Diagram	9
Analysis and Disposal of	9
Abnormal Circumstances	

Direction for Safety in Use



Warning

Any operation not based on the direction for use will cause danger.



Attention

Any operation against rules may damage your goods and/or properties, and even harm your personal safety.

- When using this product, you are required to carefully read the operation instructions in this Manual and keep this Manual properly for future reference.
- Please strictly abide by the following marks. Ignoring these marks or operation mistakes may cause major accidents or hurt others. Therefore, please abide by the following marks. (This product is only applicable to household purposes.)
- If the power line is damaged, it must be replaced by the professional personnel from the manufacturer or its maintenance department or similar department in order to avoid danger.



Attention

	Please carefully read various instructions in this Manual before using this product.		The power supply to use should be of 220-240V and more than 15A.
	Please do not use this product for any purpose beyond its functional scope.		Be sure not to allow a child to operate this product.
	Please stop using this product when the power line or plug is damaged or any of its function is disabled.		Please do not make the power line touch any sharp edge or corner or high-temperature surface.
	This product must be operated on a balanced and reliable worktable.		When pulling the plug, you are required to hold the plug but not pull the power line.
	Please do not use this product outdoors.		Please do not soak this product in water or any other liquid.
	Please do not dismantle this product arbitrarily in order to ensure safety. In case of any abnormal circumstance, please send this product to local service center or agency of this company and invite qualified maintenance personnel to overhaul it.		

Attention to Safety

■ Special Tips

Be sure to abide by the following matters needing attention to safety in order to ensure safety in use and thus avoid causing injuries and property loss to you and others.

Failure to abide by safety warnings and wrong use may cause accidents.

This product does not consider the following circumstances:

- Any infant without supervision or disabled person uses this product.
- Any infant plays with this product.

The mark “⊘” represents the “prohibited” content.

- It is strictly prohibited to operate this product under no load or at an overload when it is working.
- It is prohibited to move this product or touch any of its components in motion in order to avoid any accidental injury when it is working.
- It is prohibited to hang the power line of this product on any sharp object and it is not allowed to connect the power line to any mobile object.
- It is prohibited to use this product on an inclined or unstable worktable.
- Please do not use an inferior extension socket in order to avoid a fire accident or personal injury.
- It is prohibited to place this product in a place too close to a stove in order to prevent it from being damaged or causing a fire accident or personal injury.

The mark “●” represents the “mandatory” content.

- Please do not allow a child to independently operate or use this product, please ensure that a child will not treat this product as a toy, and it is necessary to place this product in a place out of a baby's reach. Any person, who is old, disabled or without experience in use, should use this product with guardianship and guidance.
- When the plug or any other component is damaged, it is a must to stop using this product and invite professional personnel of any designated maintenance center to replace or repair this product and thus prevent it from causing any injury.
- Before unpacking or testing any component of this product, please ensure that this product is disconnected from power supply.
- If the power line is damaged, it must be replaced by the professional personnel from the manufacturer or its maintenance department or similar department in order to avoid danger.
- Please do not use any accessory or fitting other than original accessories and fittings of this product in order to avoid fire accidents and personal injuries.
- Please do not allow any infant without supervision to run this product.

The mark “▲” represents the matters possibly causing casualties.

- Before using this product, it is necessary to ensure that the voltage is consistent with its specification (220~240V, 50Hz) in order to prevent this product from suffering any safety-related danger and damage.
- With regard to working time of this product, it is a must to ensure that continuous stirring time does not exceed 6 minutes. During the operations, if the chassis overheats, it is necessary to stop this product for about 20 minutes and it is not allowed to proceed with operating this product until it is cooled.

The mark “” represents the matters possibly causing slight injuries or property loss.

- This product is equipped with built-in overheating protector. When it is used abnormally or its motor runs at a serious overload, this product will automatically stop for protection. If this product cannot be started after it is protected for 30 minutes, it is necessary to send this product to a maintenance outlet of this company for maintenance and it is not allowed to dismantle this product arbitrarily.
- After using this product, it is necessary to clean all the positions touching food in order to prevent this product from sending forth peculiar smell after being not used for a long time.
- If this product gets stuck during its use, please immediately turn off it, pull out the power plug, remove the container, take out the material(s) leading this product to getting stuck and then continue using it after the motor is cooled.
- After using this product, you are required to timely pull out the power plug and clean this product.
- Before using this product, you are required to ensure that the worktable is clean and greasy dirt is eliminated timely.
- Please keep the optimal distance of more than 30 cm between this product and any other kitchen appliance.

Specification

Voltage	Frequency	Moter Power	Cup capacity	Heater power
220-240V~	50/60Hz	1500W	1.75 Liters	800W

- a. This appliance shall not be used by children. Keep the appliance and its cord out of reach of children.
- b. Appliances can be used by persons with reduced physical, sensory or mental capabilities or lack of experience and knowledge if they have been given supervision or instruction concerning use of the appliance in a safe way and if they understand the hazards involved.
- c. Children shall not play with the appliance.
- d. Appliances shall warn of potential injury from misuse.
- e. Always disconnect the appliance from the supply if it is left unattended and before assembling, disassembling or cleaning.
- f. The appliance shall state that care shall be taken when handling the sharp cutting blades, emptying the bowl and during cleaning
- g. Be careful if hot liquid is poured into blender as it can be ejected out of the appliance due to a sudden steaming.
- h. Switch off the appliance and disconnect from supply before changing accessories or approaching parts that move in use.
- i. The appliance must not be immersed.
- j. The heating element surface is subject to residual heat after use.
- k. When using the appliance, avoid spillage of water on the connector as this may cause damage to the appliance.
- l. Do not misuses use this appliance, it must be occur damage.
- m. CAUTION: In order to avoid a hazard due to inadvertent resetting of the thermal cut-out, this appliance must not be supplied through an external switching device, such as a timer, or connected to a circuit that is regularly switched on and off by the utility

Schematic Diagram of Components

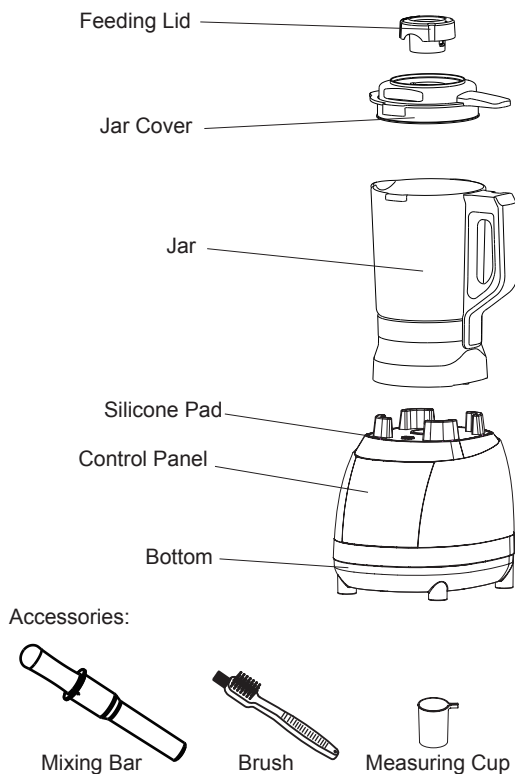

Component Name	Introduction to Function
Feeding Lid	It is used to prevent food material(s) from splashing and the stirring rod can be inserted into the stirring cup after it is removed.
Jar Cover	It is used to prevent food material(s) from splashing and this product cannot be started until the cup cover is installed in place.
Jar	It is a container holding food material(s), including a knife for smashing food material(s)
Silicone Pad	It is used to rotate the jar and reduce noise.
Bottom	It acts as the power source of this product.
Control Panel	It is used to control the working manner of machine.
Mixing Bar	It is used to give assistance in food smashing (for instance, smoothie function).
Brush	It is used to clean this product.
Measuring Cup	It is used to measure and get food materials such as dry beans and rice.



Matters Needing Attention to Use:

The above diagram is used for reference only due to difference in appearance of product. Specific diagram is subject to the physical object in the box.

Direction for Use

■ Notice before Use:

1. The volume should not exceed the maximum scale.
2. The exterior of main body can be wiped with dry cloth. Please neither soak the main body in water or any other liquid nor rinse the main body under water or any other liquid in order to avoid leakage of electricity or prevent components of this product from being damaged.
3. When cleaning this product, please rinse its cup body and parts with clean water and then dry it with cloth; the cutter blade is very sharp, so you should be careful in order to prevent it from hurting you when cleaning it. You can wear protective gloves.
4. Please do not clean this product with any steel wire ball, abrasive detergent or corrosive liquid (such as gasoline or acetone).
5. The maximum volume should not exceed 1400mL when this product is used to make soy-bean milk.
6. Please clean the food material(s) and cut it or them into pieces with the length of a side not exceeding 2cm.

■ Description of Control Panel:

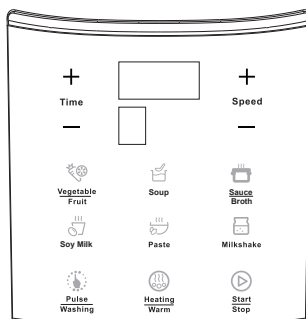

(This picture is just a schematic diagram and the specific diagram should be subject to the physical object.)

S.N.	Mode	Purpose(s)
1	Vegetable Fruit	This program is used to make vegetable & fruit juice, mixed fruit juice and so on. It is without the function " Heat ".
2	Soup	This program is used to make soup.
3	Sauce/ Broth	This program is used to make various sauce and borth.
4	Soy Milk	This program is used to make various soy-bean milk, nut pulp milk with tastes based on recipes.
5	Paste	This program is used to make rice paste in recipes.
6	Milkshake	This program is used to make various milk shakes in recipes. It is without the function " Heat ".
7	Pulse/Washing	This program is used to make smoothies, clean the cup and so on. It is used for intermittent operations. When making smoothies, using a stirring rod for assistance can achieve better effect; after adding an appropriate amount of water, intermittently press the " Pulse/Washing " button can simply clean the jar.
8	Heating/Warm	This button is used to heat food in the jar or keep inside food warm.
9	Start/Stop	This button is for start off/on or stop blender during working;

Usage

1. Cut the food material(s) into pieces about 2cm.

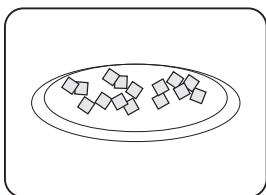

3. Pour the measured food material(s) into the jar.

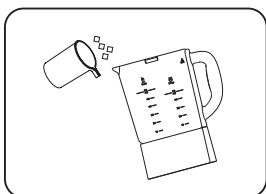

5. Align the ears on both sides of the jar cover at the lugs of the rim of jar in a staggered manner, press the jar cover into the jar, and then rotate the jar cover clockwise till it buckles the jar body and finally press the feeding lid tightly onto the jar cover (wherein the jar body is equipped with an uncovering protective device which will not power on this product if the jar cover is not rotated in place).

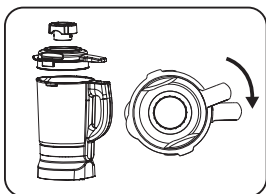

7. After the power line is plugged and this product is powered on, all its backlights twinkle and then go out, the buzzer sounds once and the time \ displays " - - - - ".

2. Use a small measuring cup to get an appropriate amount of food material(s) as per the proportions in recipes and personal tastes.

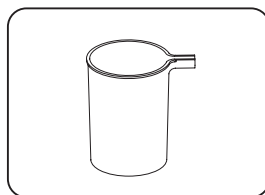

4. Add an appropriate amount of clean water to the jar.
(Increase or decrease an appropriate amount of water as per the proportions in recipes)

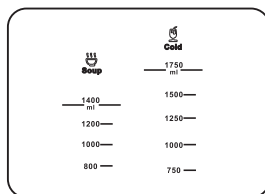

6. Place the jar at the right position on the host machine.

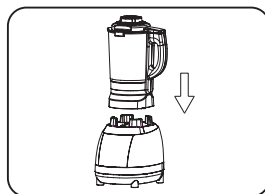

8. Select functional buttons by jogging.

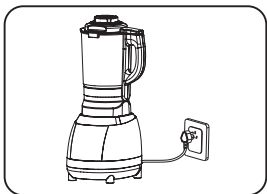

9. Press the “Start/Stop” button when this product starts to work!
(The fast and slow sound during the work of this product belongs to normal design.)

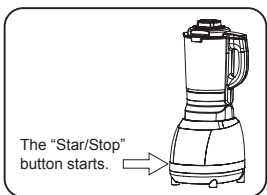

11. Pull out the power line, remove the jar and then open the jar cover.
(Note: It is necessary to prevent the gushing steam from scalding you when opening the jar cover!)

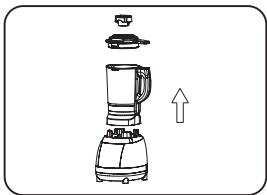

13. Please timely clean the interior of the jar and use wet cloth to clean the shell of this product.

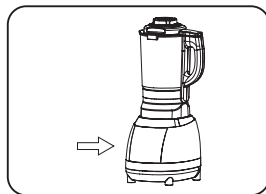
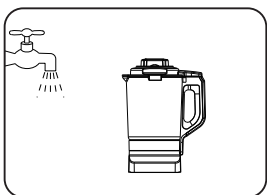

10. When this product finishes its work, the buzzer sounds three times and then this product returns to the standby mode.

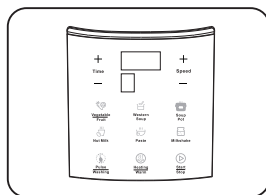

12. Pour out the seriflux and add seasonings as per personal taste.
(Please do not pour out the seriflux too violently in order to prevent the liquid from splashing.)

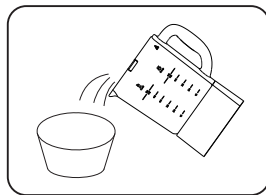

14. After rubbing away the water stains on the surface of this product, separately place the host machine and the jar in a cool and well-ventilated place for drying in order to avoid the appearance of peculiar smell.

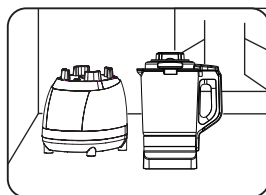

Matters Needing Attention:

1. When making western soup, rice paste, soup and so on, it is a must to select corresponding functional buttons. Otherwise, the made beverage may be of poor taste, not cooked thoroughly and suffer other problems. In a serious case, the beverage even will overflow or adhere to the bottom!
2. If it is necessary to switch the functions such as " PASTE ", " WESTERN SOUP " and " SOUP POT " due to functional errors, please click the " Start/Stop " button to cancel the current function. Before the current function is counted down, you may directly re-select the corresponding function just by clicking the " Start / Stop " button. If the current function has been counted down, you are suggested to replace the food material(s) and then re-select the correct function for starting.
3. The share(s) of food material(s) in any recipe are prepared as per standard water level. Therefore, a user may adjust the share(s) of food material(s) as per the amount of water and kind(s) of food material(s) wherein the highest water level under the function " Heat " had better not exceed 1,400 mL and the highest water level under the function " Cold Drink " had better not exceed 1,750mL.
4. When making beverage based on fruits and vegetables, please denucleate food material(s) with kernels in advance and then put the food material(s) into the jar and finally add an appropriate amount of drinking water or milk.
5. Please do not use this product to directly heat thick liquids such as milk, soy-bean milk and cold rice paste. Otherwise, food will be burnt on bottom of jar during heating.
6. When the machine is working, please pay attention to the water vapor spraying out and hot water splashing out from the spout after the liquid in the jar boils. Be sure not to open the jar cover when the machine is working.
7. When the machine is making any beverage, please do not add seasonings (such as sugar) to the jar in order to prevent the seasonings from adhering to the bottom of the when being heated.
8. Before powering on the machine, please ensure that the jar, the jar cover and the feeding lid are installed in place.
9. When this product is powered on, it is strictly prohibited to insert any hand or sharp-pointed object into the jar in order to prevent you from being injured or this product from being damaged.

Cleaning and Maintenance

Cleaning

1. After the jar makes fruit juice and the latter is poured out, it is necessary to immediately add clean water and use the mode " Pulse / Washing " repeatedly to better clean the jar.
2. After this product is powered off, the exterior of main body can be wiped with dry cloth. Please neither soak the main body in water or any other liquid nor rinse the main body under water or any other liquid in order to avoid leakage of electricity or prevent components of this product from being damaged.
3. When cleaning this product, please rinse its cup body and parts with clean water and then dry it with cloth; the cutter blade is very sharp, so you should be careful in order to prevent it from hurting you when cleaning it. You can wear protective gloves.
4. Please do not clean this product with any steel wire ball, abrasive detergent or corrosive liquid (such as gasoline or acetone).
5. If any component of this product is colored by fruit and/or vegetable juice, it is necessary to add several drops of edible oil before rinsing it to better eliminate the color.
6. Thoroughly wipe such component dry after rinsing it with clean water.

■ Maintenance

1. It is appropriate to frequently use this product to keep its motor dry.
2. If it is not used for a long time, it is necessary to store this product in a dry and ventilated place in order to keep its motor from moisture.

Schematic Circuit Diagram

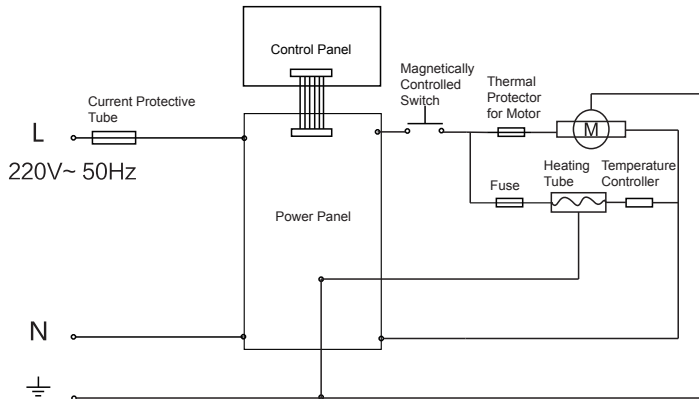

(Note: The wiring is subject to change without notice.)

Analysis and Disposal of Abnormal Circumstances

■ Disposal of Abnormal Circumstances

1. It is necessary to immediately power this product off and stop using it if it is in abnormal circumstances such as abnormal noise, peculiar smell and smoke.
2. If this product fails to work, please check whether the power line is connected properly or not, whether its switch is turned on or not and whether the stirring cup is installed in place or not.
3. If this product still fails to work upon above check, please send it to any designated maintenance center for maintenance and consulting.

■ Failure Analysis and Troubleshooting

Failure	Possible Cause(s)	Solution
The power indicator light does not go on.	The power line is not inserted well.	Check the power line and ensure that it is inserted well.
The indicator light goes on but this product does not work.	Not press the " Start " button after selecting the target function.	Press the " Start/Stop " button after selecting the target function.
	The cup cover is not covered in place.	You will hear short sound of the buzzer after re-covering the cup cover well and installing it in place.
A button does not respond.	The system is not reset due to short power disconnection interval.	Power on and use this product after disconnecting its power supply for 3 minutes.
	This product has been executing the program.	It is a normal phenomenon.
The food cannot be smashed.	The added water is too much or less.	Please add water to the correct water level.
	The power voltage is too low.	You may use a household voltage stabilizer.
	The food material(s) is/are too much or less.	Please operate as per the recipe.
The food adheres to the bottom.	The interior of cup is not clean.	Use this product after cleaning the interior of its cup.
	The added food material(s) is/are too much.	Please operate as per the recipe.
	Press a wrong functional button.	Select a correct functional button.
E1	The food material(s) is/are cut into too big pieces.	Pull out the power line for disconnecting the power supply, pour out the food material(s) in the cup and then cut it/them into appropriate small pieces.
	There is/are too much material(s).	
	The machine itself goes wrong.	Clean the water of coupler surface.
	The coupler surface has water.	
E2	The machine is continuously burned with nothing.	Pull out the power line for disconnecting the power supply and then re-insert the power line to return to normal.
	The cup is directly lifted when this product is working without interruption of power supply.	
	The machine itself goes wrong.	Clean the water of coupler surface.
	The coupler surface has water.	
E3	The machine is continuously burned with nothing.	Pull out the power line for disconnecting the power supply and then re-insert the power line to return to normal.
	The machine itself goes wrong.	
	The coupler surface has water.	Clean the water of coupler surface.
E4	The machine goes wrong.	Contact our after-sale customer service center for maintenance.
	The coupler surface has water.	Clean the water of coupler surface.



At the end of its service life, this product may not be disposed of as urban waste. It must be taken to a special local authority differentiated waste collection centre or a dealer providing this service. Disposing of a household appliance separately avoids possible negative consequences for the environment and health deriving from inappropriate disposal and enables the constituent materials to be recovered to Obtain significant savings in energy and resources. As a reminder of the need to Dispose of household appliances separately, the product is marked with a crossed-Out wheeled dustbin.